

# LIO G25

## Product data sheet

Name	
Model ID	LIO G25
Energy efficiency class	C
Direct heat output	7,0 kW
Indirect heat output	0 kW
Energy efficiency index (EEI)	87
Fuel energy efficiency at nominal heat output	83,3%
Fuel energy efficiency at minimum load (partial load)	–
Note for special prerequisites for assembly, installation or maintenance of the single room heating unit	<ul style="list-style-type: none"><li>· The fire protection and safety distances, among others for flammable materials, must be observed in any case.</li><li>· This device must comply with the applicable installation conditions connected and may only be placed in an adequately ventilated room will. Before installing and using the device Read instructions</li><li>· The requirements from the manual regarding assembling, installation, use and maintenance has to be followed.</li><li>· Operating licence exclusively for Germany and only in combination with the air exhaust system (LAS) from the company EKA Edelstahlkamine</li></ul>



**Erwin Koppe – Keramische  
Heizgeräte GmbH**

Koppe-Platz 1  
D – 92676 Eschenbach i.d.OPf.

Fon: 09645 88–100

Fax: 09645 1048

Mail: [info@ofenkoppe.de](mailto:info@ofenkoppe.de)

**[ofenkoppe.de](http://ofenkoppe.de)**

# LIO G25



Body black | steel with stainless steel cover

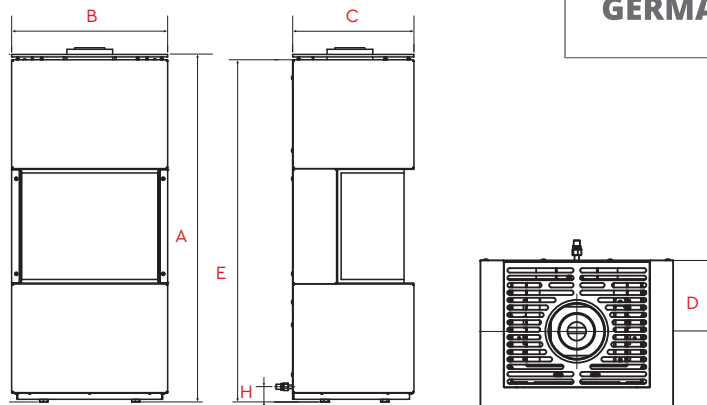

**LIO G25**  
steel

## Technical values

Rated heat output	7,0 kW
Rated heat output water	-
Rated heat output air	-
Heat output area	3,5 - 7,0 kW
Energy efficiency class	<b>C</b>

## Dimensions and weights

Height in cm, approx.	116	<b>A</b>
Depth in cm, approx.	52	<b>B</b>
Depth in cm, approx.	41	<b>C</b>
Rear edge to centre of upper exhaust socket in cm, approx.	19	<b>D</b>
Height to upper edge of pipe socket connection top in cm approx.	114	<b>E</b>
Height of gas connection in cm approx.	5	<b>H</b>
Main gas connection	3/8 Zoll	
Minimum wall distance, side / rear / area sight window in cm approx.	20   10   100	
Weight in kg, approx.	114	

## Fuels

Suitable fuels	Natural gas G25
----------------	-----------------

## Room heating capacity\*

Room heating capacity approx.	71 - 182 m <sup>3</sup>
Nox-class	4
Efficiency	1

## Inspection

EN 613

### Basic model (body black)



black steel  
incl. remote control

### Special models (body black)



black steel  
incl. WiFi box  
for myfire app



**Erwin Koppe – Keramische  
Heizgeräte GmbH**

Koppe-Platz 1  
D – 92676 Eschenbach i.d.OPf.

Fon: 09645 88-100  
Fax: 09645 1048

Email: [info@ofenkoppe.de](mailto:info@ofenkoppe.de)

**ofenkoppe.de**

The indicated sizes and weights are non-binding approximates. Deviations of size and weight indications, production tolerances, construction changes and print errors are possible at all times and are reserved.



GAS OVEN



**ENERG**  
енергия · ενέργεια



**Koppe**

LIO G25



**C**

7,0  
kW

ENERGIA · ЕНЕРГИЯ · ΕΝΕΡΓΕΙΑ · ENERGIJA · ENERGY · ENERGIE · ENERGI

2015/1186

